

ATTENZIONE: verificare con la concessionaria Scania che il veicolo sia predisposto per montare la PTO.
ATTENTION: check with your Scania dealer that the vehicle is ready for the PTO.

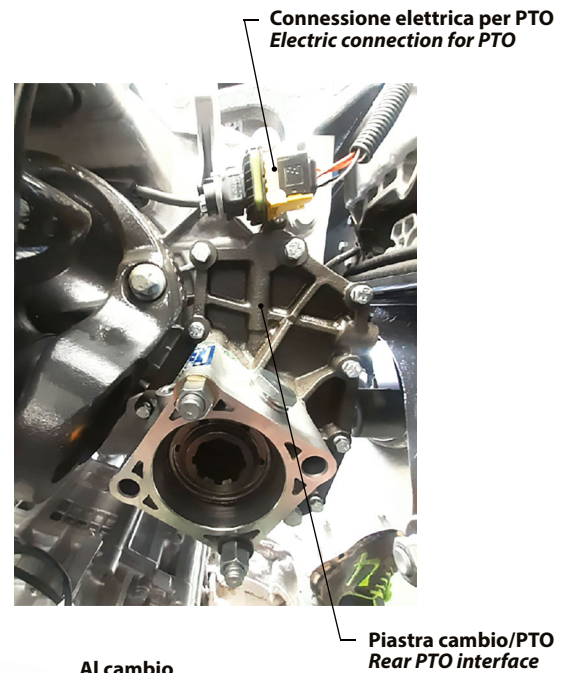

1	Connessione PTO PTO connection	V111	4-pin DIN
Pos.	Funzione Function	Designazione Designation	Tipo Type

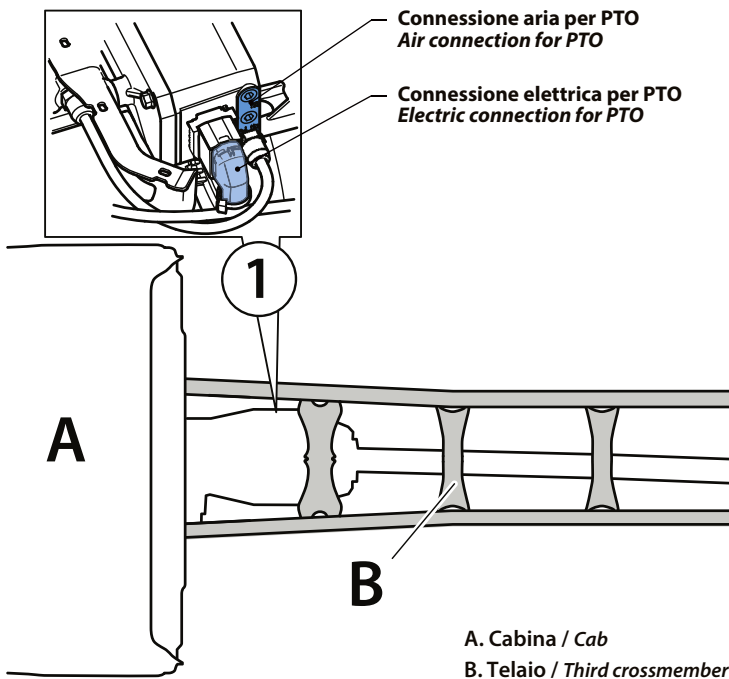
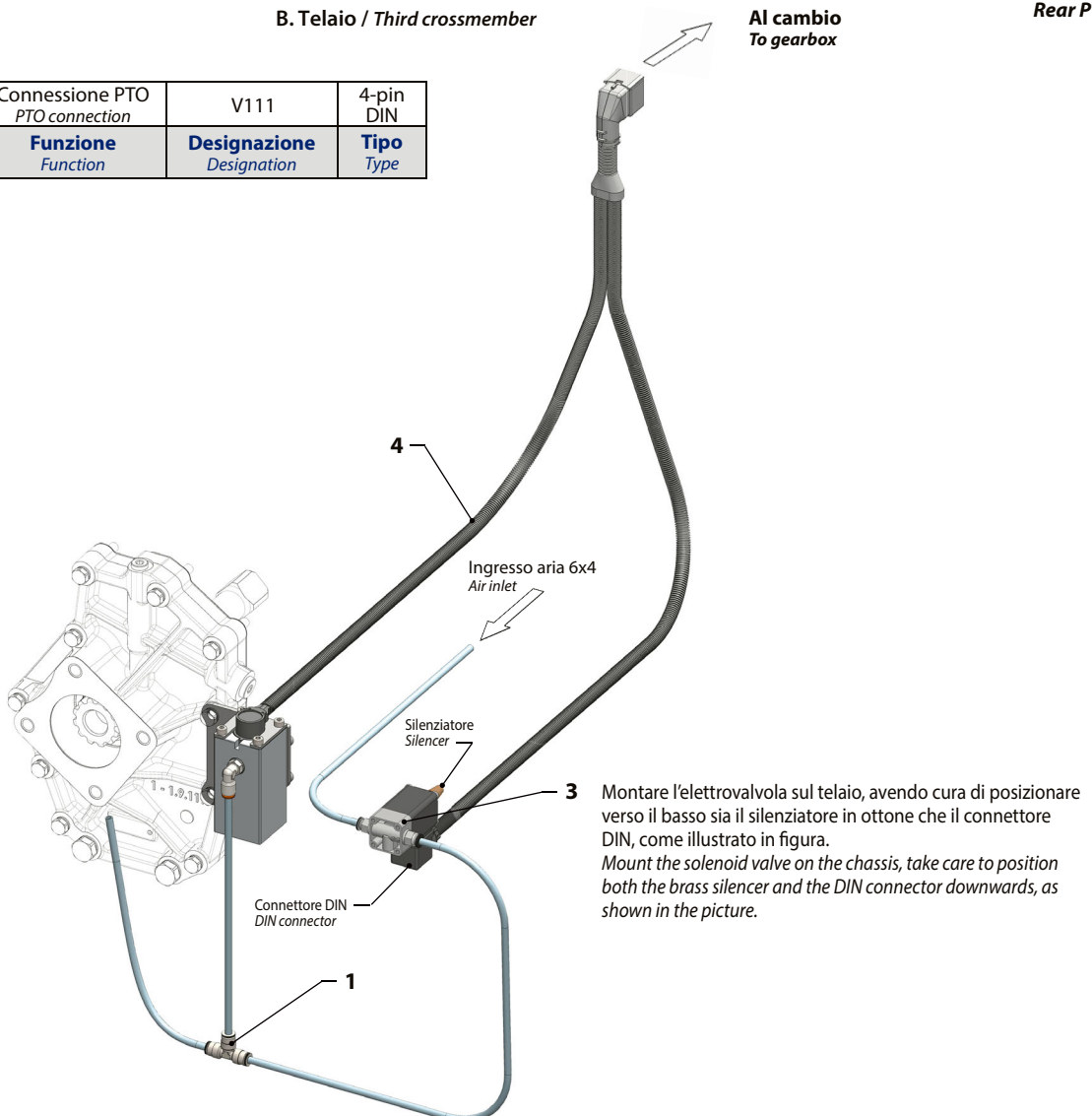

Istruzioni di montaggio / Mounting instructions

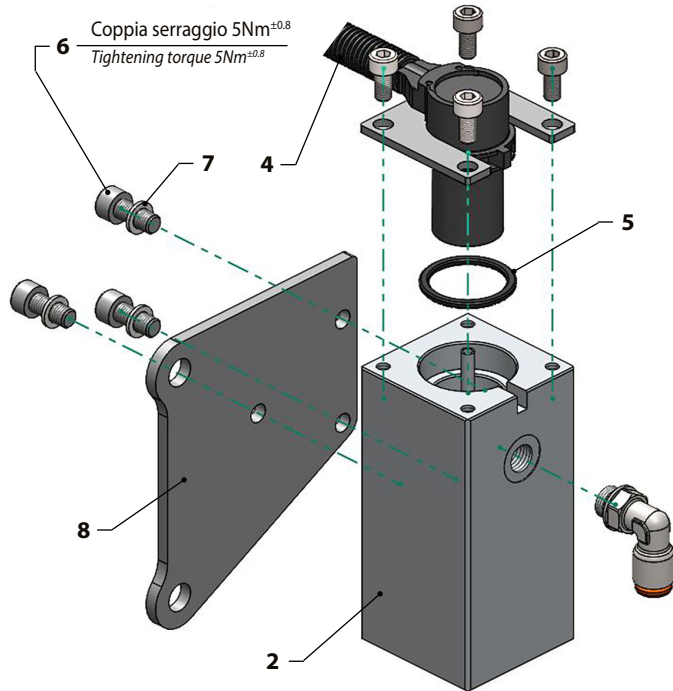
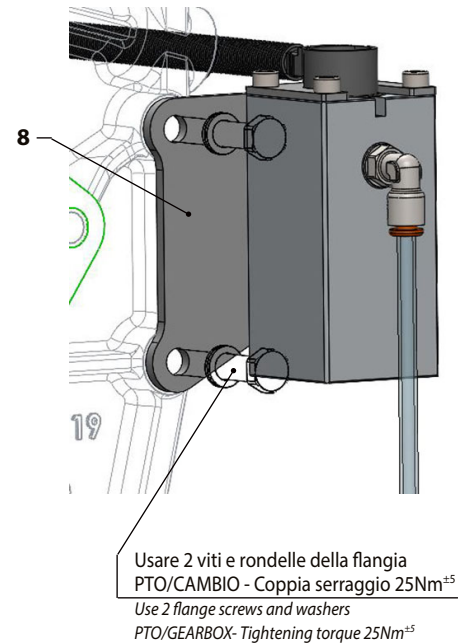
A Montaggio cilindro e staffa / Assembly of cylinder and bracket

B Montaggio staffa su adattatore / Assembly bracket on adaptor

8	53800404860	Piastra fissaggio cilindro pneumatico / Pneumatic cylinder mounting plate	1
7	50102000067	Rosetta SCHNORR x M6 tipo S / SCHNORR washer for M6 S type	3
6	50200200432	Vite TCE UNI 5931 M6x14 / Screw TCE UNI 5931 M6x14	3
5	50600200194	OR 3093 (Ø2,62 x Ø23,47)	1
4	30600103829	Cablaggio / Wiring	1
3	10001500082	Elettrovalvola pneumatica 3/2-NC-24cc / Pneumatic solenoid valve 3/2-NC-24cc	1
2	10002600105	Cilindro pneumatico / Pneumatic cylinder	1
1	10001700053	Raccordo aria a "T" tubo 6x4 / "T" air fitting pipe 6x4	1
N°	Codice / Code	Descrizione / Description	Q.

C

DOPO AVER MONTATO IL KIT, É TASSATIVO RIVOLGERSI AD UN CONCESSIONARIO SCANIA PER LA PARAMETRIZZAZIONE DELLA CENTRALINA
AFTER MOUNTING THE KIT, IT IS IMPERATIVE TO CONTACT A SCANIA DEALER FOR PARAMETERIZATION OF THE CONTROL UNIT